

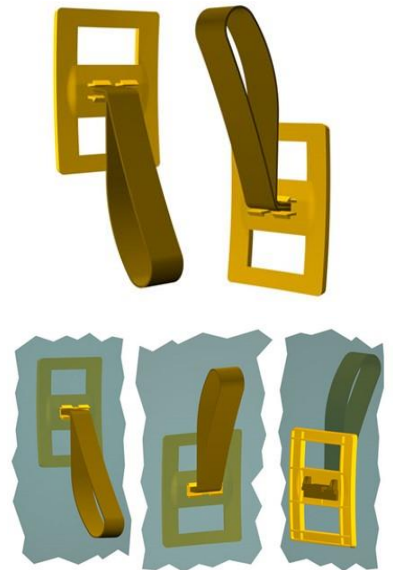

## Data sheet EKS 889.7 Loop handle

Our Loop handle EKS 889.7

- is equipped with a plastic loop
- possesses a robust plastic plate
- offers easy hand access because the loop is preformed
- is used for carrying and lateral drawing of bulky packages
- possesses sturdy barbs so that the plate is anchored in the cardboard box wall
- offers the possibility of mounting the loop pendent or upright
- is an alternative to the Loop handles EKS 885.0 and EKS 887.0
- can be loaded up to 75 kg
- is part of our E-K-S Bioline®
- 100% recyclable



### Technical specification:

Weight approx. 32.20 gr.

Raw material depending on the variant:

- 70% HDPE (standard material) / 30 % HDPE regranulate (PIR)
- 100% PP- Recycled material (PCR)
- 100% E-K-S Bioline® sugar cane

### Packaging:

100 pcs. / 3.6 kg

400 pcs. / 13.2 kg

### Assembling data:

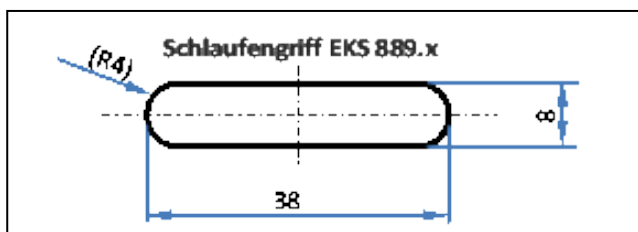

Assembling data  
(punching)

A = 38 mm (+/-1mm)

B = 8 mm (+/-1mm)



Did you already know that we can also manufacture our products from biological raw materials on request? We will be pleased to provide you with further information!

