



Data sheet EKS 809.0 Heavy lift handle

Our Heavy lift handle EKS 809.0

- offers high carrying comfort due to its strongly rounded edges
- can be mounted easily
- can be loaded up to 35 kg or 55 kg depending on the material used
- is part of our E-K-S Bioline®
- 100% recyclable

Technical specification:

Weight approx. 15.90 gr.

Raw material depending on the variant:

- 70% LDPE (standard material) / 30 % LDPE regranulate (PIR)
- 70% HDPE (standard material) / 30 % LDPE regranulate (PIR)
- 100% E-K-S Bioline® sugar cane

Packaging:

250 pcs. / 4.4 kg

750 pcs. / 12.6 kg

Assembling data:

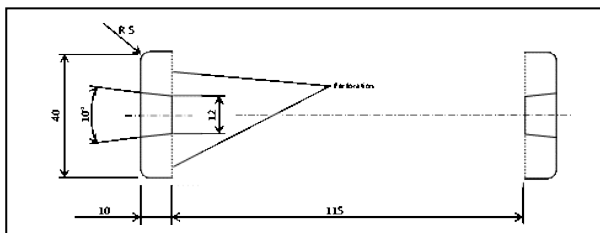

Assembling data
(punching)

A = 40 mm (+-1mm)
B = 10 mm (+-1mm)
C = 12 mm (+-1mm)
D = 10 mm (+-1mm)
E = 115 mm (+-1mm)
F = 5 mm (+-1mm)

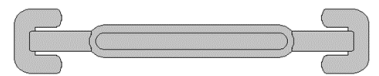

Did you already know that we can also manufacture our products from biological raw materials on request? We will be pleased to provide you with further information!

